



## Bohemia Road, St. Leonards-On-Sea TN37 6RL

Offers in excess of £120,000



A bright one bedroom GARDEN APARTMENT situated in a sought after position within immediate walking distance of local shops, and good transport links and equidistant to Hastings Town centre and the hub of St. Leonards On Sea where there are a collection of independent stores, eateries and a mainline railway station benefitting from connections to London. The accommodation here spans the GROUND FLOOR of this period property and is arranged as a spacious living room with a separate modern fitted kitchen which is positioned at the rear of the property benefitting from access to the low maintenance courtyard garden. There is a DOUBLE BEDROOM together with a shower room. This fantastic property is being sold with NO ONWARD CHAIN.

GROUND FLOOR  
481 sq.ft. (44.7 sq.m.) approx.

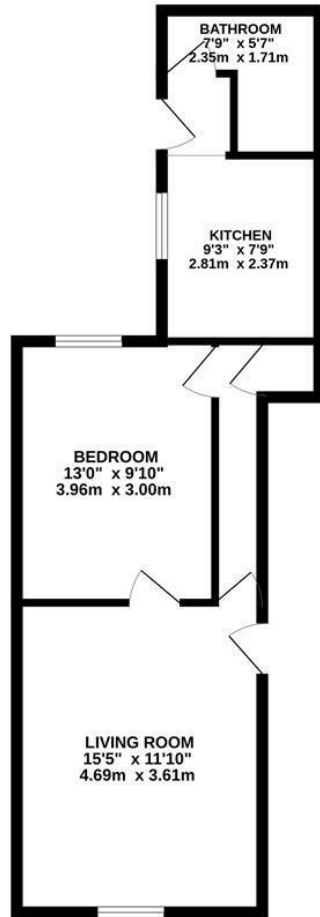

TOTAL FLOOR AREA: 481 sq.ft. (44.7 sq.m.) approx.

Whilst every attempt has been made to ensure the accuracy of the floorplan contained here, measurements of doors, windows, rooms and any other items are approximate and no responsibility is taken for any error, omission or mis-statement. This plan is for illustrative purposes only and should be used as such by any prospective purchaser. The services, systems and appliances shown have not been tested and no guarantee as to their operability or efficiency can be given.  
Made with Metrepx ©2025

